

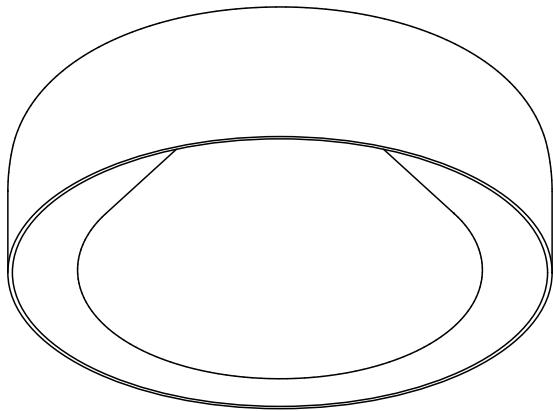

Highline Flush-Mount

21438 rB

Low Voltage Input



CAUTION:

Before starting, turn off power
at main circuit panel.

ADVERTENCIA:

Antes de comenzar la instalación,
apague la corriente en el tablero
principal.

ATTENTION:

Coupez l'alimentation avant de
procéder à l'installation.



Calling for backup? Scan above
to contact our team.

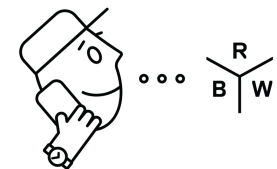
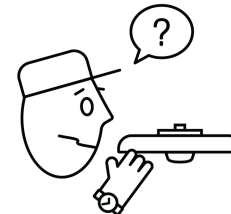

www.RBW.com
+1 212 388 0399
support@RBW.com
© 2023, RBW Studio LLC

What's Included: Part Configurations May Vary

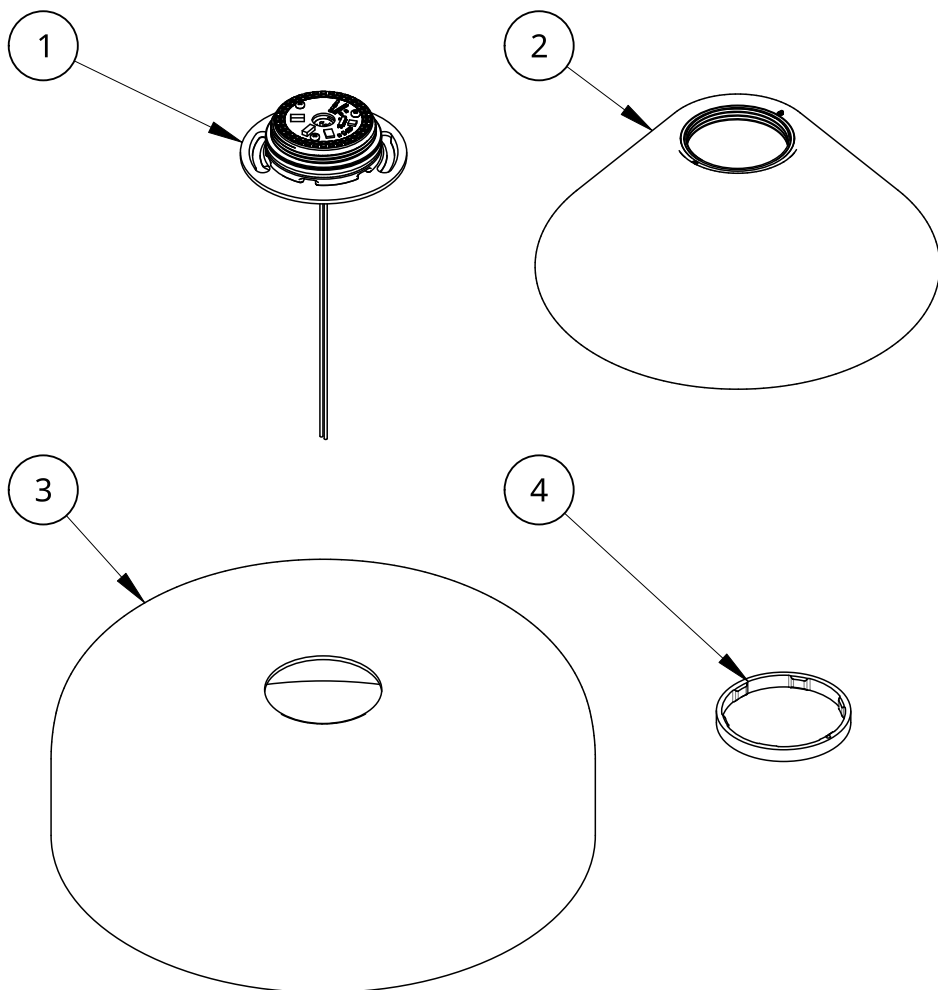

Item	QTY	Description
1	1	Assembly: Highline. Flush-Mount. LED Module
2	1	Assembly: Highline Cone Difuser
3	1	Highline Felt Shade
4	1	Highline Spacer Ring



Driver dimensions and location may vary, consult your order confirmation for details.

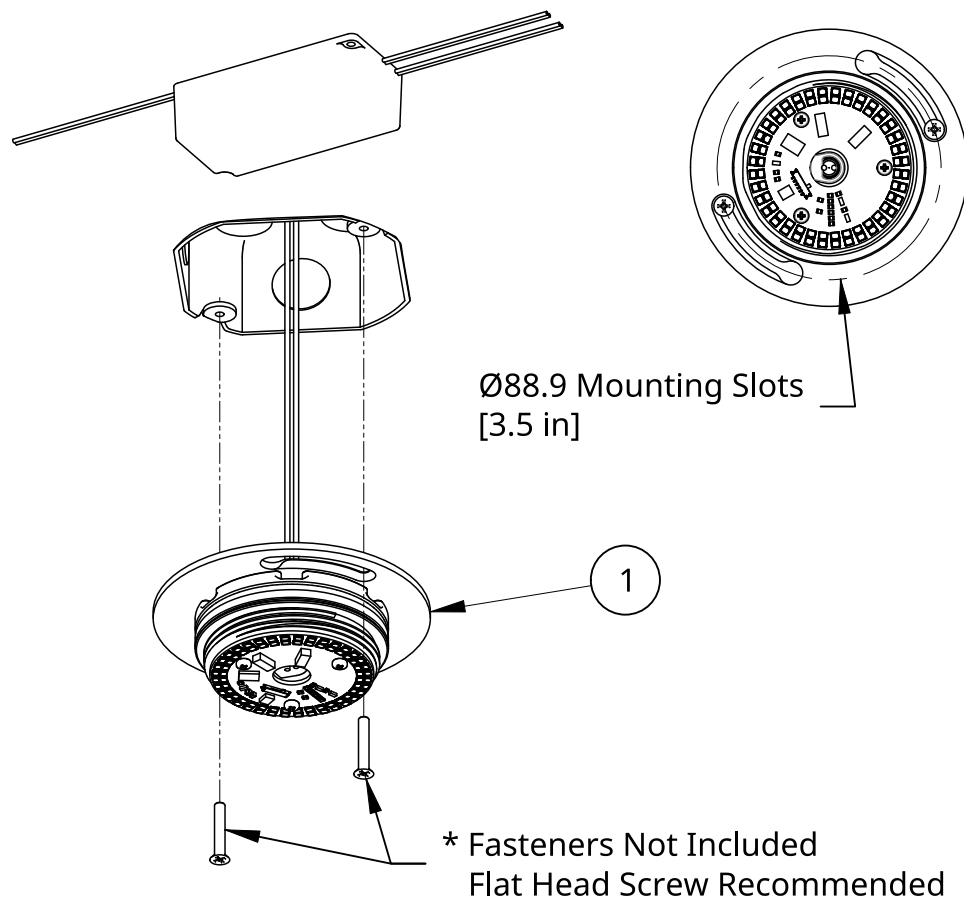

Installation - LED Module

1. Connect Red (+) and Black (-) wires to low voltage leads from externally located driver.
2. Fix LED Module to desired mounting surface with appropriate fasteners.

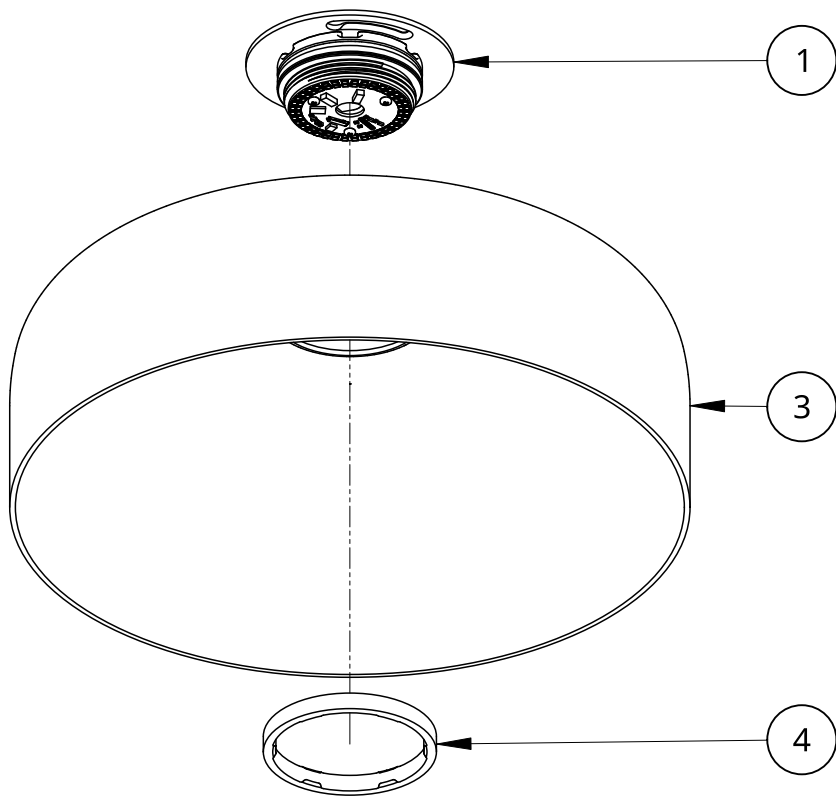

Installation - Shade & Spacer Ring

3. Place Felt Shade over LED Module so it sits flush with the mounting flange.
4. Press Spacer Ring onto LED Module to hold the Felt Shade in place.

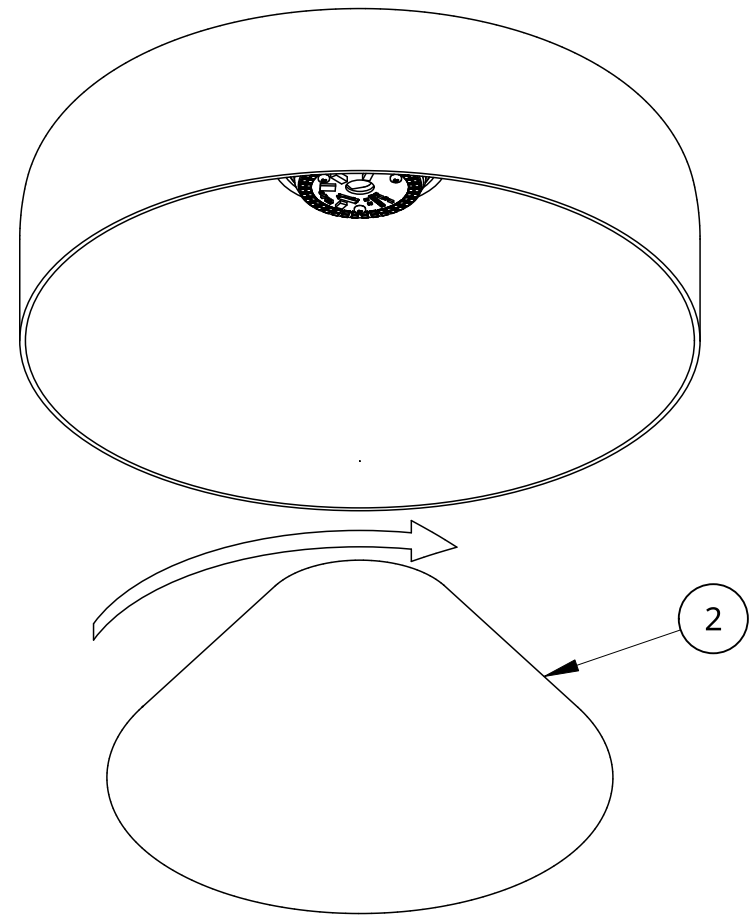

Installation - Cone Diffuser

5. Thread Cone Diffuser clockwise onto LED Module.
6. Congratulations! End of guide.